

WNFL	74,23 m2
BALKON	8,00 m2

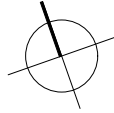

A detailed floor plan of a 10-story building. The plan shows a central corridor system with rooms on either side. A specific area, consisting of two adjacent rooms, is highlighted in red. This red area is located in the middle-right section of the plan, between the central corridor and the rightmost wing. The rooms are numbered, and the red area corresponds to the rooms labeled '10' and '11' in the original image. The building has a symmetrical layout with a central core and two main wings.

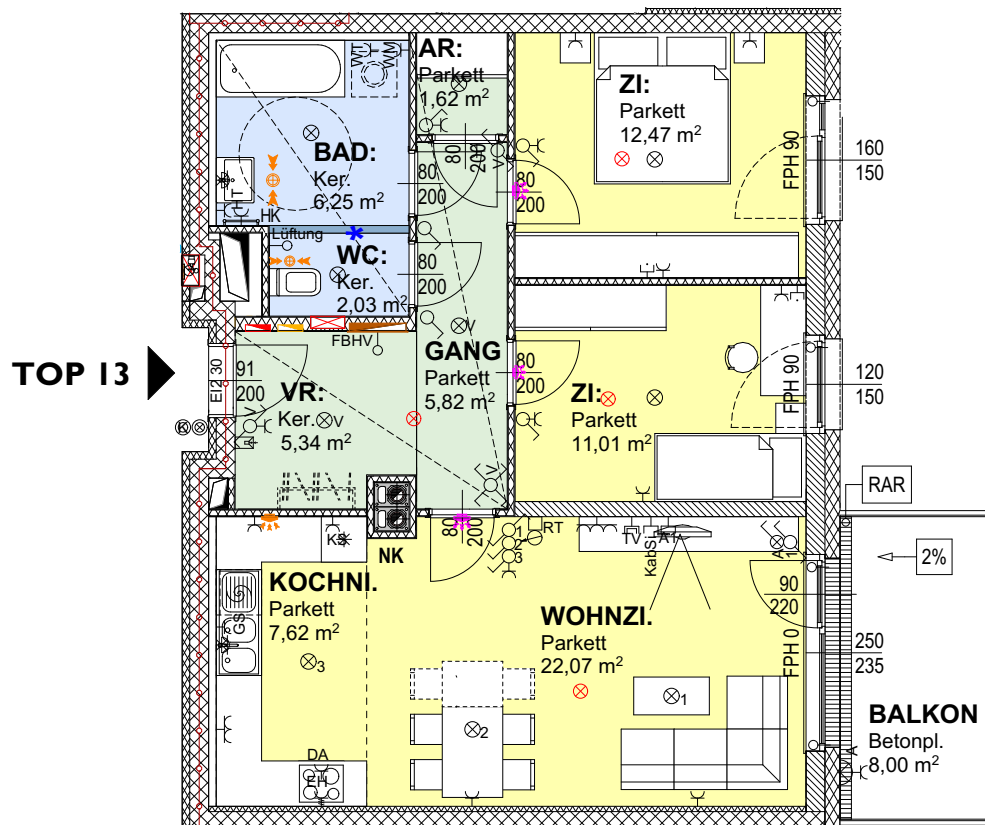

MASS E PRÜFEN, NATURMASS NEHMEN! ALLE MASS SIND
ROHBAUMMASS UND NICHT ALS GRUNDLAGE FÜR DIE EINRICHTUNG ZUVERWENDEN!
VORBEHALTLICH ARCHITEKTONISCH UND TECHNISCH NOTWENDIGER ÄNDERUNGEN.
DIE DARGESTELLTEN EINRICHTUNGSGEGENSTÄNDE SIND LEDIGLICH EIN
EINRICHTUNGSVORSCHLAG DES PLANERS!